

# PLAN OF GOVERNMENT PROPERTY

FORMERLY BELONGING  
TO  
**JOHN BONNER E<sup>SQR.</sup>**

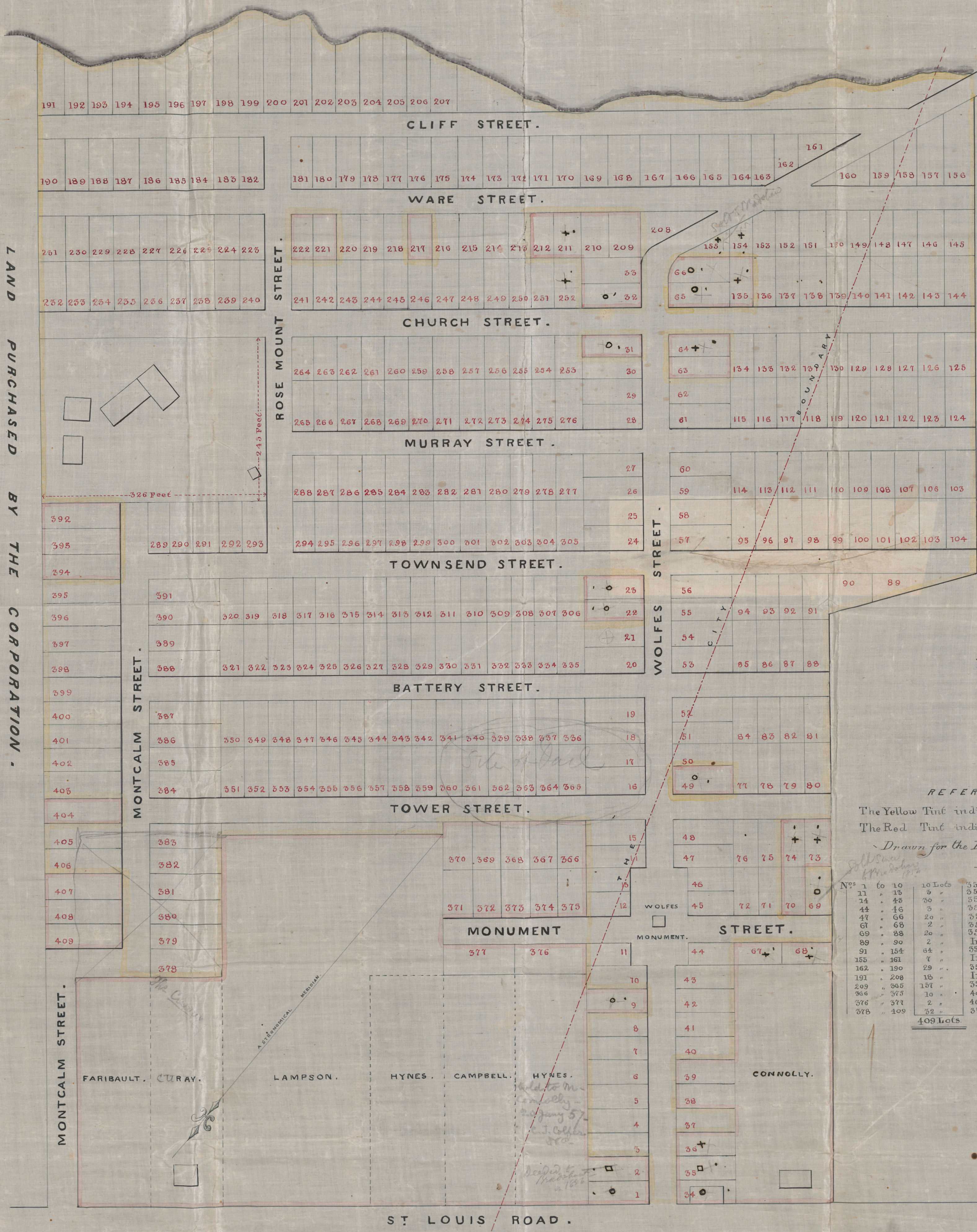

LAND PURCHASED BY THE CORPORATION.

RACE COURSE

REFERENCES  
The Yellow Tint indicates "GOVERNMENT PROPERTY"  
The Red Tint indicates "VARIOUS PROPRIETORS"  
Drawn for the Public Works Department  
By *S. P. McGeough*  
*Draughtsman*

Nos 1 to 10	10 Lots	35 by 66
11	15	35 by 64
14	48	35 by 66
44	16	35 by 66
47	60	35 by 66
61	65	35 by 66
69	88	35 by 70
89	99	Irregular
91	154	35 by 70
155	181	Irregular
182	190	35 by 70
191	208	Irregular
209	245	35 by 70
264	275	40 by 70
276	271	46 by 108
278	409	35 by 106
409 Lots		

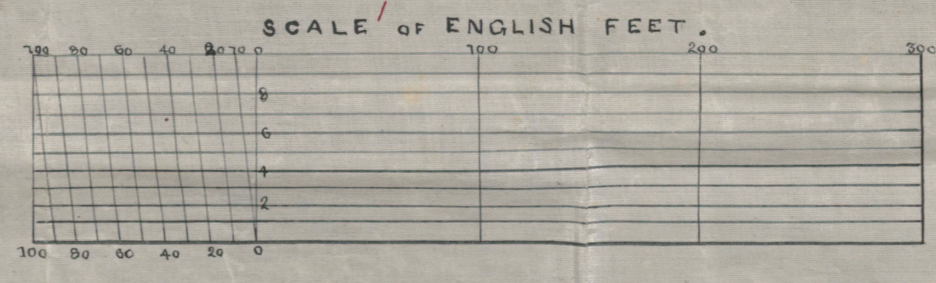

*Lot excepted in Grant Deed from Down & Co. (Merchants)*  
*○ Lots marked on Plan in Office of S. B. LeMay (Notary, Quebec)*  
*+ Lots marked on Plan in Office of W. D. Campbell (Notary)*  
*□ Lots marked on Plan in Office of N. W. Bowen (Notary)*  
 July 26<sup>th</sup> 1854 *J. P. K.*

*Quebec February 1856.*